

PTZ Enclosure



PART NO. P7012-0001

Copyright © 2025
All rights reserved.

Original Instructions: English

All rights reserved throughout the world. No part of this publication may be stored in a retrieval system, transmitted, copied or reproduced in any way, including, but not limited to, photocopy, photograph, magnetic or other record without the prior agreement and permission in writing of the Videndum

Disclaimer

The information contained in this publication is believed to be correct at the time of printing. Videndum Ltd reserves the right to make changes to the information or specifications without obligation to notify any person of such revision or changes. Changes will be incorporated in new versions of the publication.

We are making every effort to ensure that our publications are updated on a regular basis to reflect changes to product specifications and features. Should this publication not contain information on the core functionality of your product, please let us know. You may be able to access the latest revision of this publication from our website.

Videndum Ltd reserves the right to make changes to product design and functionality without notification.

Trademarks

All product trademarks and registered trademarks are the property of Videndum.

All other trademarks and registered trademarks are the property of their respective companies.

Published by:

Videndum Ltd

Email: technical.publications@Videndum.com

Contents

Warning Symbols Used in these Instructions	4
Assembly	7
Mounting options	7
Camera plate mounting.	8
Setting the Camera Plate	10
Horizontal Setting	10
Cable management	13
Removal and Fitting of Reflective Glass Panel	14
Panel Orientation.....	14
To attach the monitor	16
Routine Maintenance.....	18
Cleaning	18
Environmental considerations	18

Safety

Important information on the safe installation and operation of this product. Read this information before operating the product. For your personal safety, read these instructions. Do not operate the product if you do not understand how to use it safely. Save these instructions for future reference.

Warning Symbols Used in these Instructions

Safety cautions are included in these instructions. These safety instructions must be followed to avoid possible personal injury and avoid possible damage to the product.



WARNING!

Where there is a risk of personal injury or injury to others, comments appear supported by the warning triangle symbol.

Where there is a risk of damage to the product, associated equipment, process or surroundings, comments appear supported by the word '**CAUTION**'.



ELECTRIC SHOCK

Where there is a risk of electric shock, comments appear supported by the hazardous voltage warning triangle.

Intended Use

The PTZ prompter is intended for use by television camera operators within a TV studio environment.



WARNING! Risk of electric shock. Always disconnect and isolate the product from the power supply before attempting any servicing or removing the covers.



CAUTION! The products must be connected to a power supply of the same voltage (V) and current (A) as indicated on the products. Refer to the technical specifications for the products



CAUTION! Only use the power cable specified for the products and certified for the country of use.



CAUTION! Using alternative power sources will invalidate the system EMC liability.

Basic Electrical Insulation (Class 1 Equipment)



WARNING! This product is Class 1 equipment. For safe operation this equipment must be connected to a power supply that has a protective earth connection (US: ground).



WARNING! Always ensure that all power and auxiliary communications cables are routed so that they do not present any danger to personnel. Take care when routing cables in areas where robotic equipment is in use.

Water, Moisture and Dust



WARNING! Protect the product from water, moisture and dust. The presence of electricity near water can be dangerous.



WARNING! When using this product outside, protect from rain using a suitable waterproof cover.

Ventilation



WARNING! Slots and openings are intended for ventilation purposes to ensure reliable operation of the product, and protect it from overheating. Do not block or cover any slots and openings.

Operating Environment



CAUTION! The product should not be used outside the operating temperature limits. Refer to the product technical specifications for the operating limits for the product.

Cleaning



WARNING! Risk of electric shock. Always disconnect and isolate the product from the power supply before cleaning.



CAUTION! Do not use solvent or oil-based cleaners, abrasives or wire brushes.

Maintenance



WARNING! Servicing or repair of this product must only be performed by qualified and trained electrical engineers.



WARNING! The fitting of non-approved parts and accessories, or the carrying out of non-approved alterations or servicing can be dangerous and could affect the safety of the product. It may also invalidate the terms and conditions of the product warranty.



WARNING! Suffocation hazard. Store all packaging material out of reach of children.

About this User Guide

This manual describes the installation of the PTZ prompter system.

Box Contents

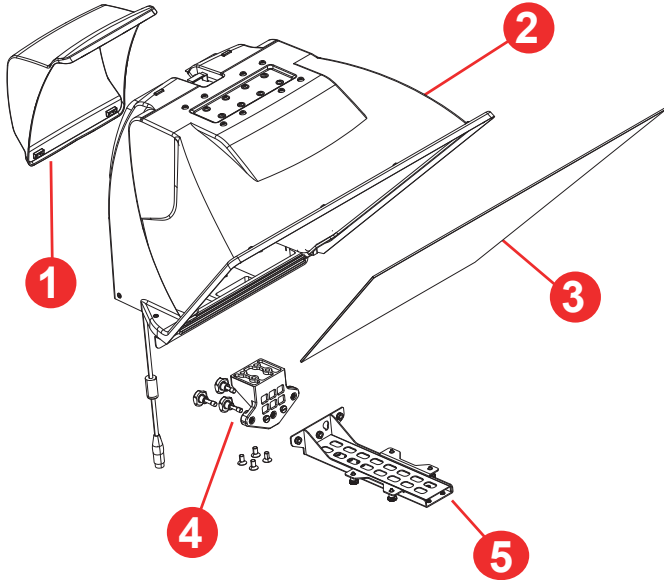

Box Contents

1	Rear Cover Assembly
2	PTZ Enclosure & PTZ mounting Assembly
3	Glass
4	Bracket Assembly
5	Monitor Bracket

Optional Monitors

Pioneer 17/19 - P7008-0953, P7008-0950, P7008-0951 and P7008-0952

Explorer 17/19 - P7010-0951 and P7010-0950

Assembly

Use the 4 x M8 x 16 mm Hex screws to mount the bracket to the hood base.
Installation of the front bracket starts at the holes on the front of the hood.

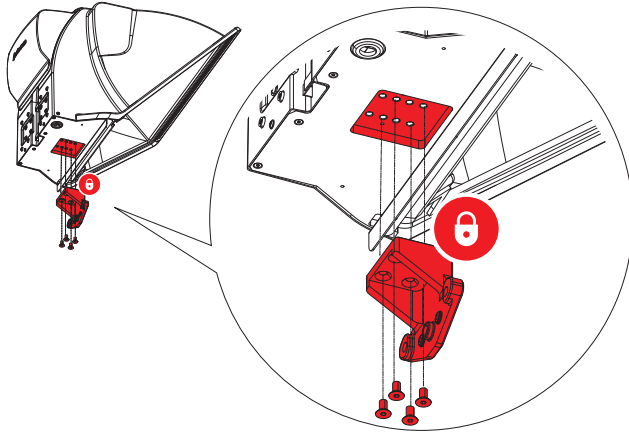

The rear cover attaches to the 4 x magnets located on the hood.

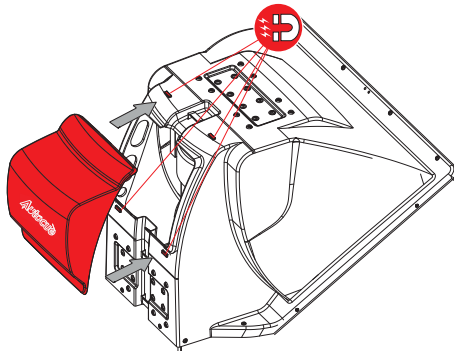

Mounting options

Use one of the mounting option (VESA or Lower Mount) to secure the assembly onto the chosen support.

Note! Suggest two people to fit, one to hold the assembly and one to fasten.

Upper Mount
VESA 100 x 100
VESA 200 x 100

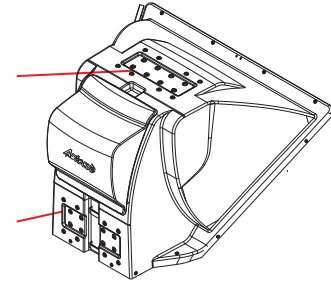

Rear Mount
VESA 100 x 100
VESA 200 x 100

Lower Mount

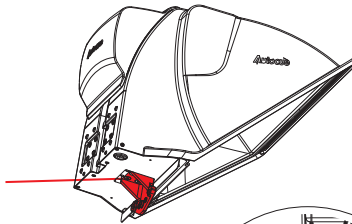

Level the assembly referring to the bubble level

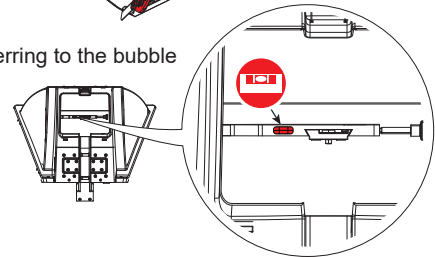

Assembly

Camera plate mounting.

Mount the camera plate to the camera using 2 x screws where possible.

The images below show the approximate position on a selection of cameras. Ensure the lens arrow on the camera plate faces in the direction of the lens.

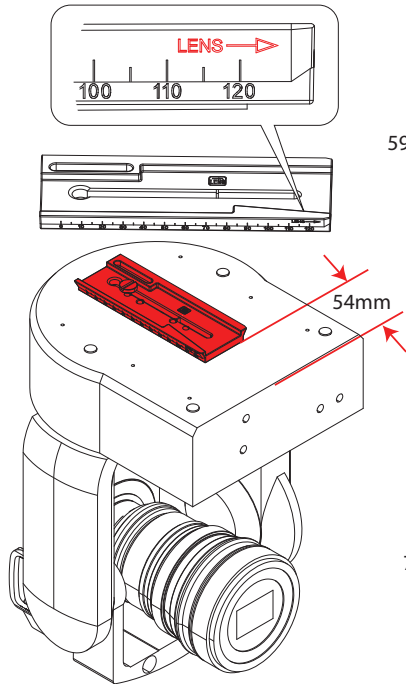

Sony ILME-FR7
For Sony ILME-FR7 installation
please remove the lens support rods

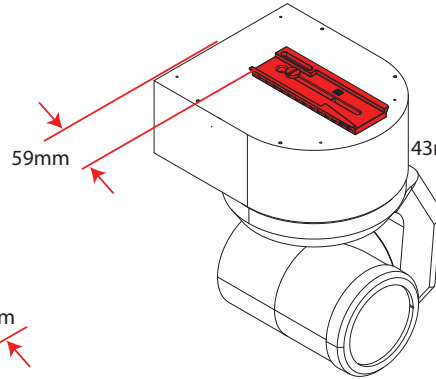

Panasonic AW-UE160

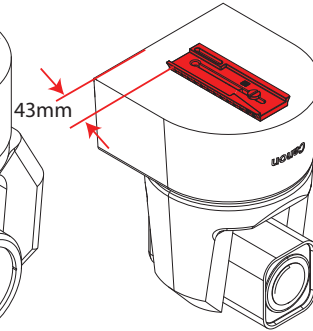

Canon CR-N700

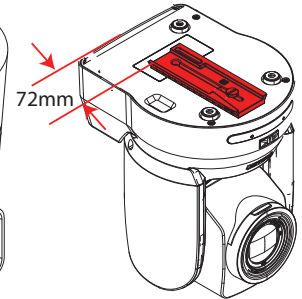

Sony BRC-X1000

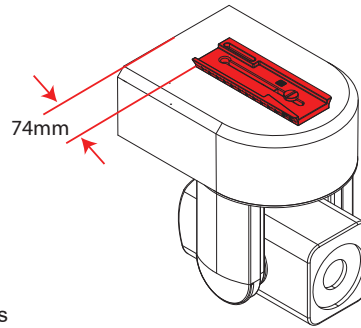

Sony BRC-AM7

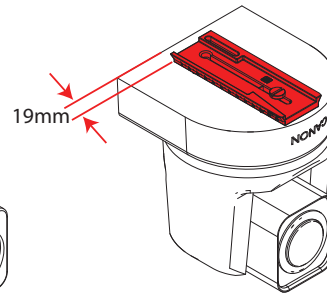

Canon CR-N300

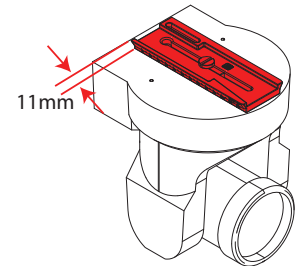

JVC KY-PZ200NWU



CAUTION!

It is recommended to fit the camera before attaching the monitor to avoid accidental damage.

Slide the camera and plate into the plate mount inside the hood.

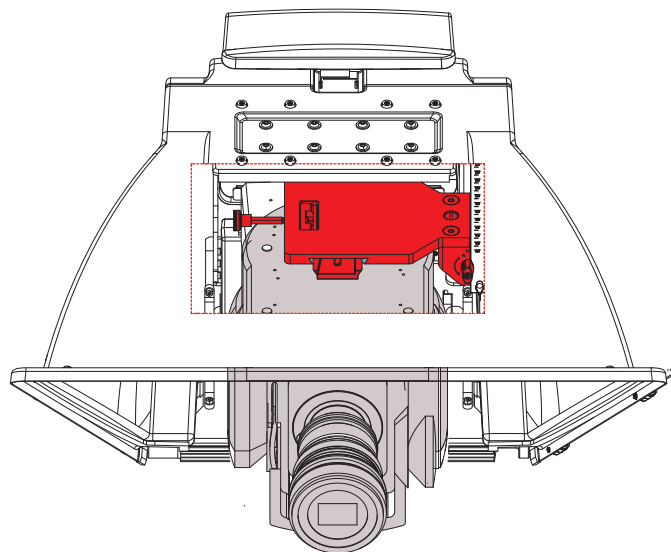
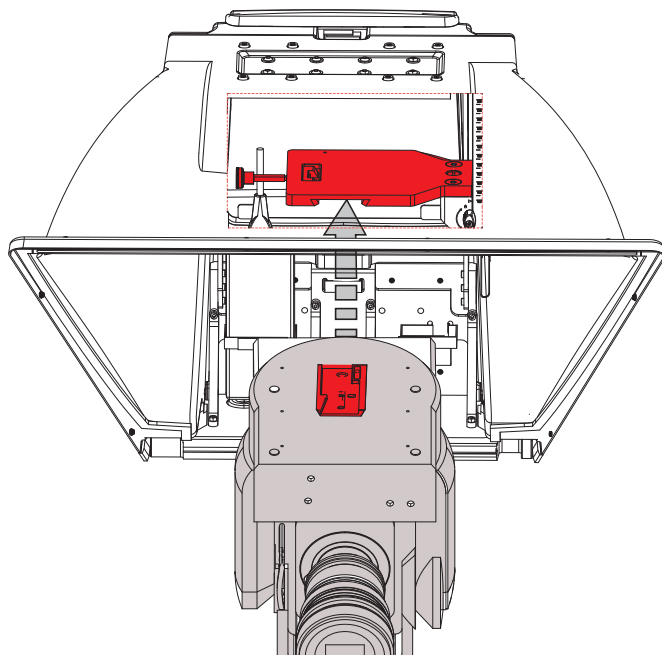

Assembly

Setting the Camera Plate

Horizontal Setting

Using the chart below use the "C Plate" reading to set the plate in position, for example Sony BRC-AM7 the plate is set to 10.

When in the desired position lock the plate using the plate lock knob.

For other cameras, set the vertical position according to the distance between the bottom of the camera and the centre of the lens

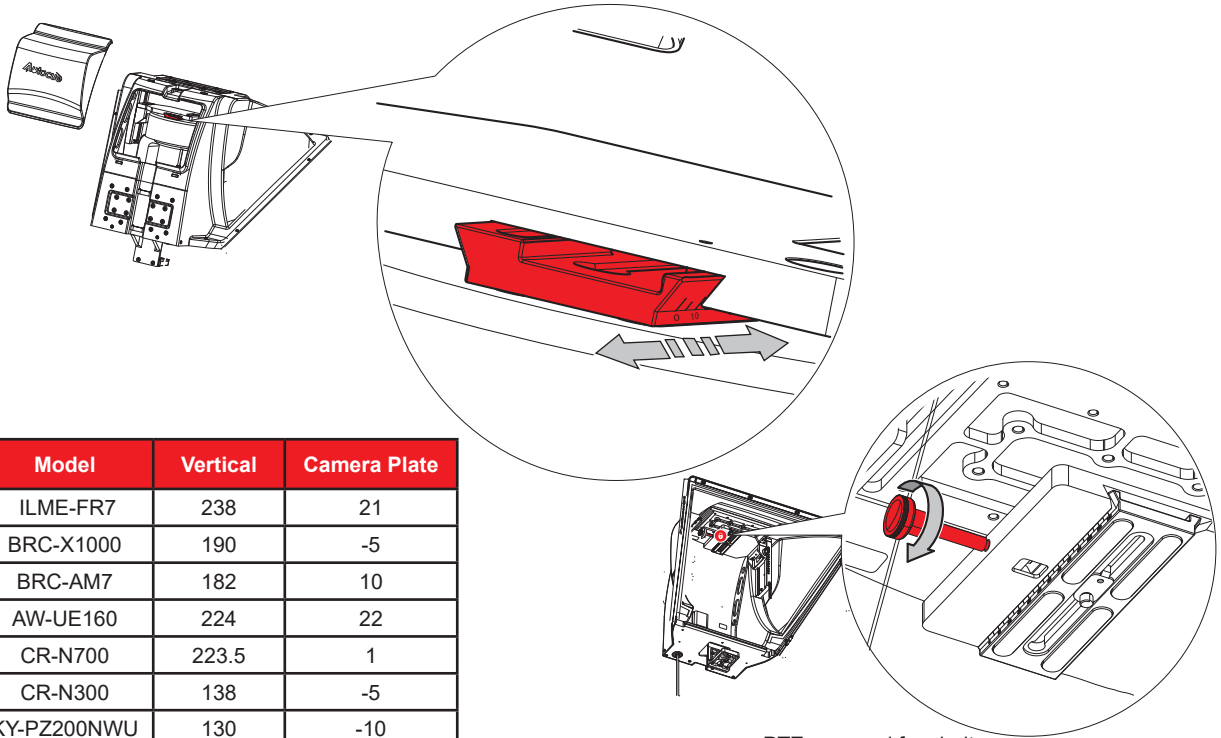

Make	Model	Vertical	Camera Plate
Sony	ILME-FR7	238	21
	BRC-X1000	190	-5
	BRC-AM7	182	10
Panasonic	AW-UE160	224	22
Canon	CR-N700	223.5	1
	CR-N300	138	-5
JVC	KY-PZ200NWU	130	-10

PTZ removed for clarity

Vertical Setting

Using the chart on Page 10 set the height using the vertical reference.
In this example, the setting is 238.
Once in position lock the plate by turning the lock knob clockwise.

For other cameras, set the vertical position according to the distance between the bottom of the camera and the centre of the lens.

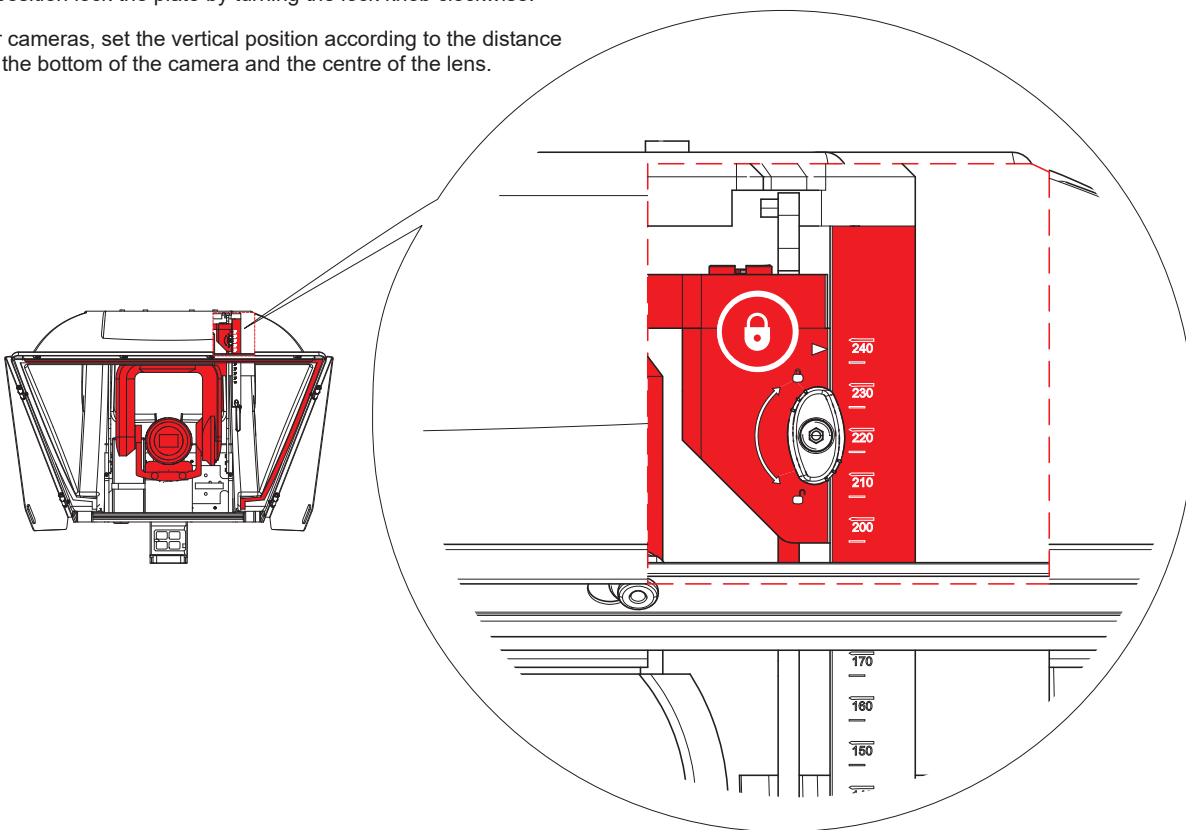

Assembly

Once locked off, remove the safety pin from its stowage and insert it into the lock position to provide extra security.

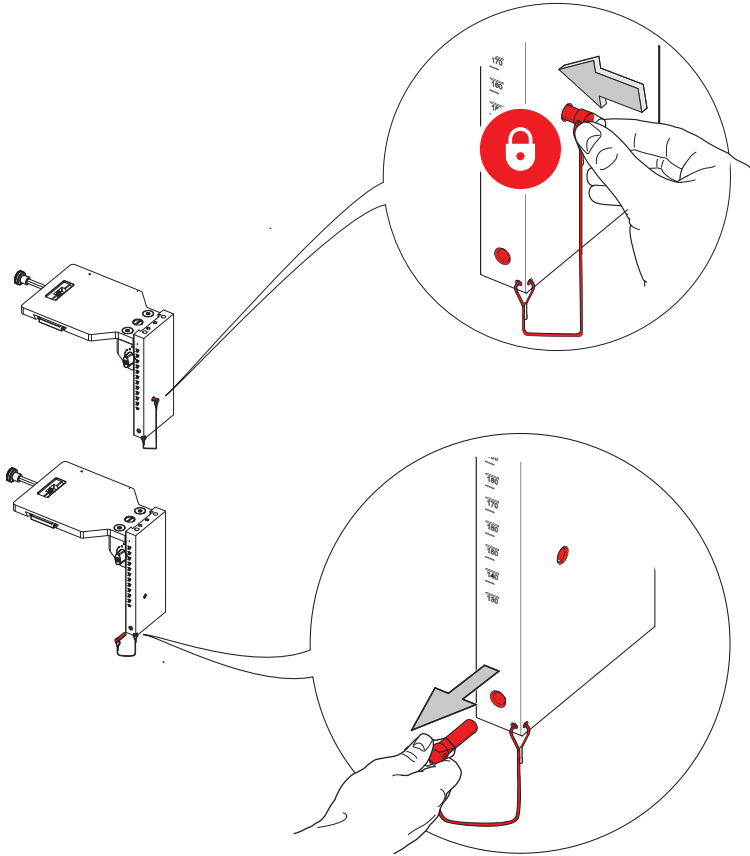

Cable management

Cables may be routed to the back or front of the PTZ, depending on connection points.

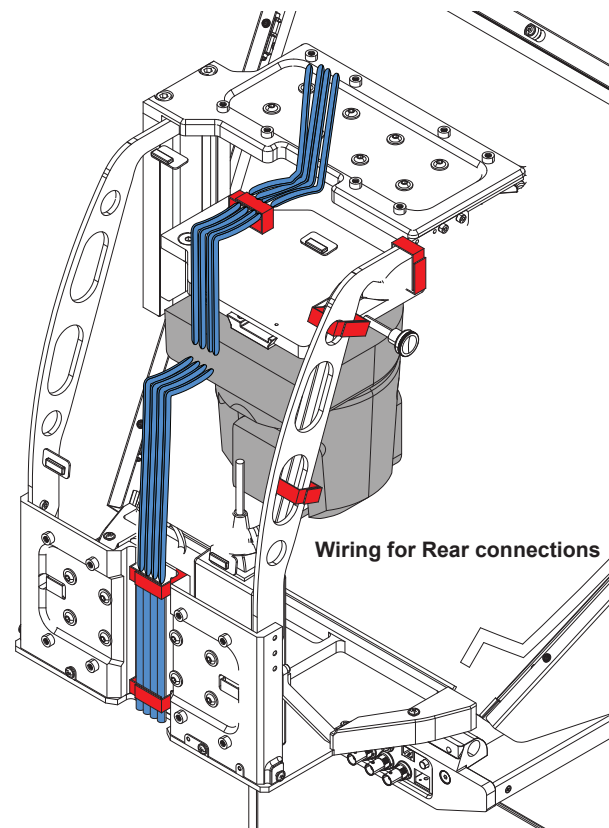
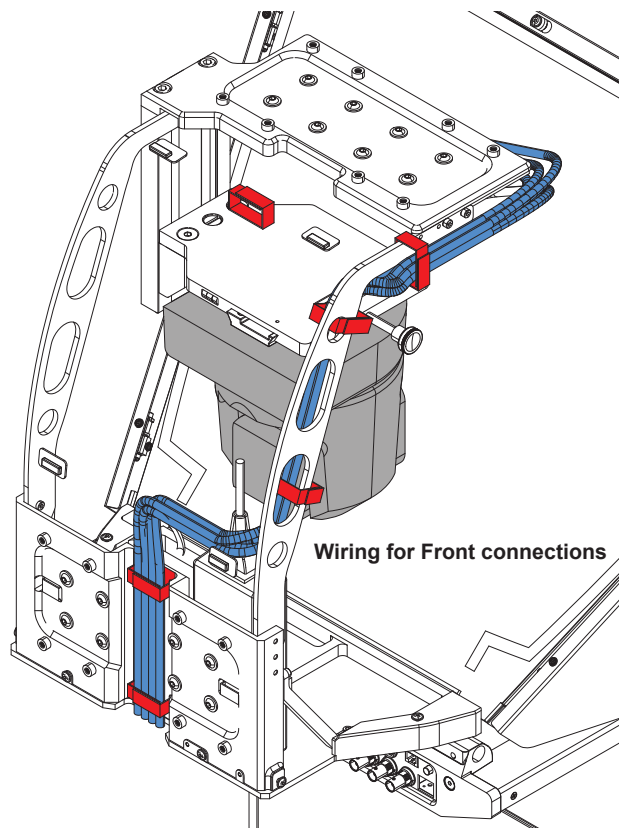

Assembly

Removal and Fitting of Reflective Glass Panel for Replacement or Cleaning



WARNING! Risk of personal injury or injury to others. Care must be taken when handling and installing the reflective glass panels.



CAUTION! Only use the correct size glass panel designed for the installed hood.

Panel Orientation

For the prompter to display images, it is essential that the reflective side of the glass is installed facing outwards. The reflective side of the glass can be identified by a removable blue sticker:

Ensure the sticker faces outward, then peel it off once the glass is secured in place.

1. Release the top glazing bar by sliding the bar to the right (when facing from the front) until the key way aligns with the bobbins and lower the bar from the hood.

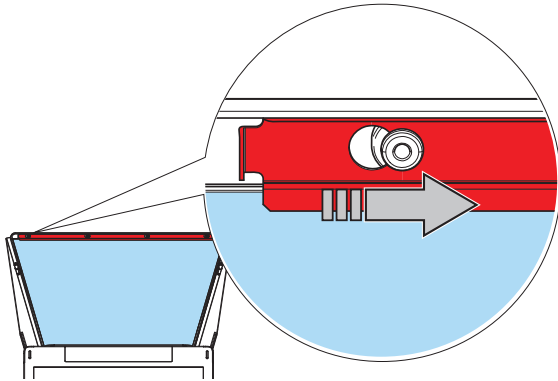

2. Carefully position the glass panel on the bottom glazing recess inside the hood, ensure the blue sticker is facing outwards.
3. Lay the glass against the foam pads.

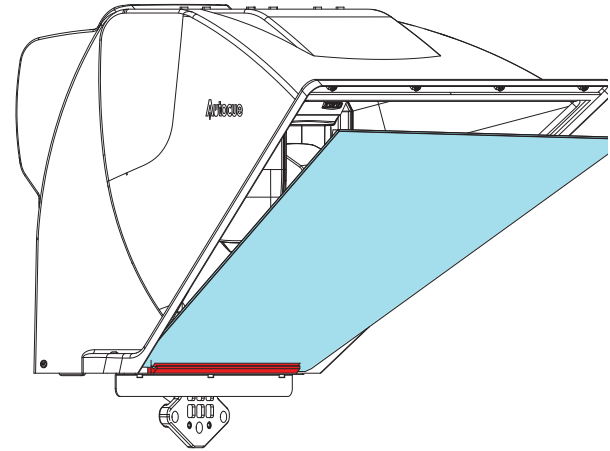

4. Secure the glass using the top glazing bar. Locate the key ways over the bobbins on the hood.

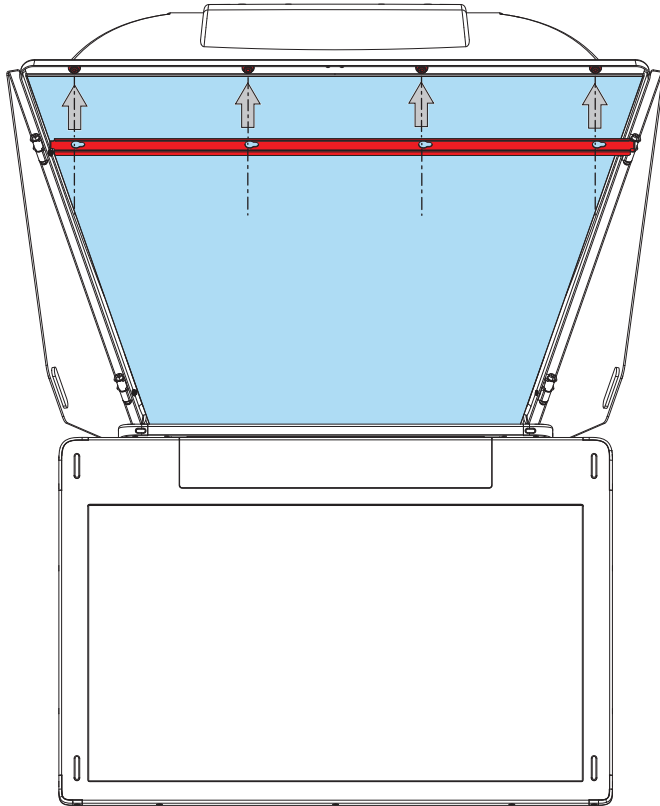

5. Slide the bar to the left (when facing from the front) until it locks into place on the bobbins.

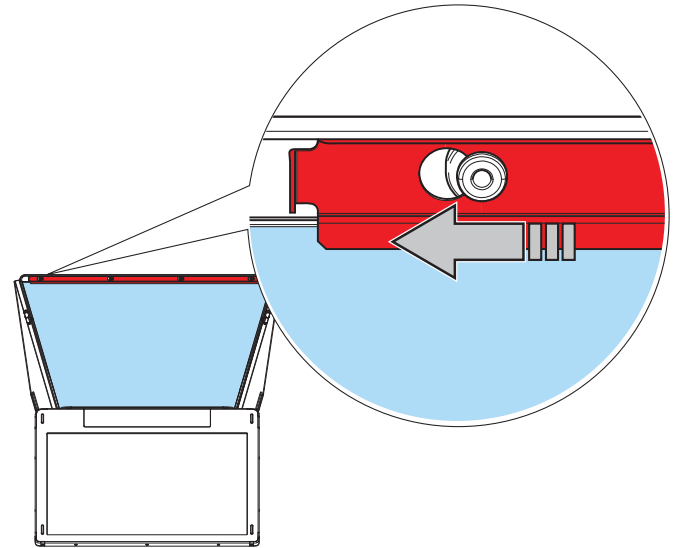

Monitor



WARNING! Before attempting to install or adjust the prompter assembly, the tilt axis of the head support must be securely locked.

To attach the monitor

1. Prepare the Monitor

Place the monitor face down on a soft cloth to protect the screen.

2. Attach to Mounting Bracket

Align the monitor's mounting holes with the 4 captive thumbscrews on the bracket. Turn the screws clockwise to secure. Do not over-tighten.

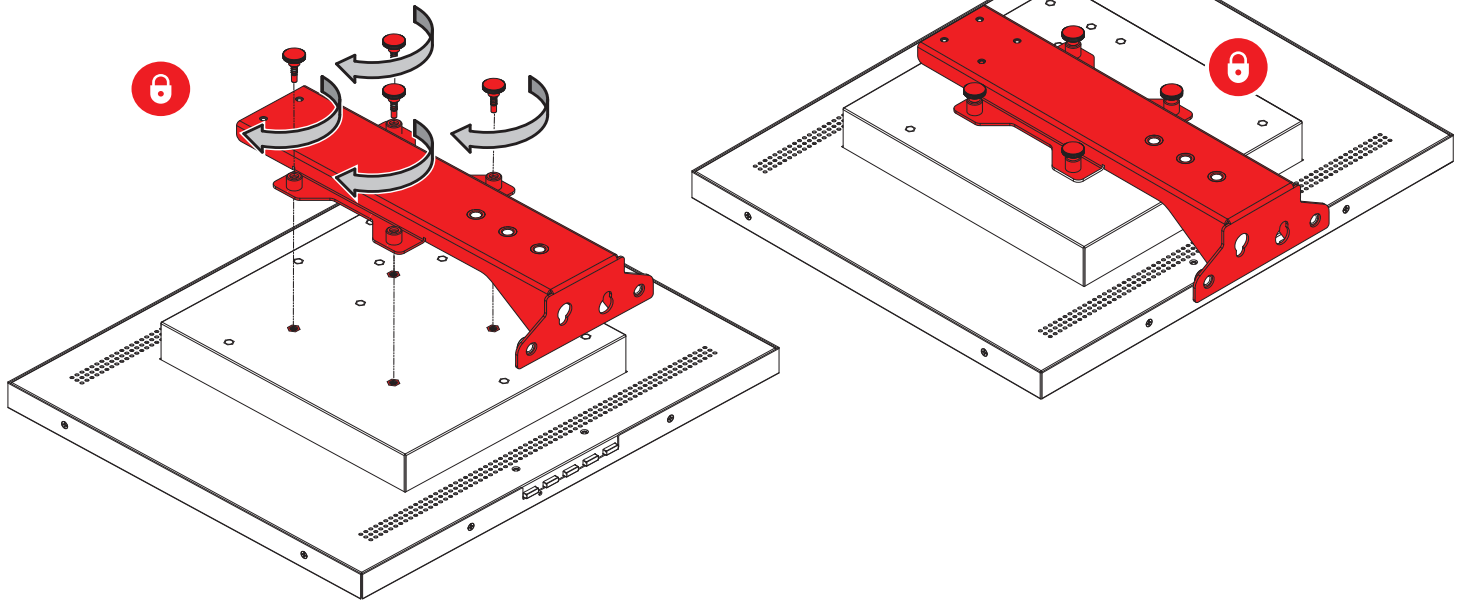

3. Attach Rail to Monitor Assembly

- Connect the rail to the monitor and bracket assembly.

4. Mount to Rail Bracket

- Align the keyholes on the rail with the fixed screws on the rail bracket.

- Twist the assembly slightly clockwise to align the key-ways.
- Then twist anticlockwise to let the bracket drop into place.

5. Secure the Assembly

Tighten the 3 thumbscrews to lock the monitor assembly in position.

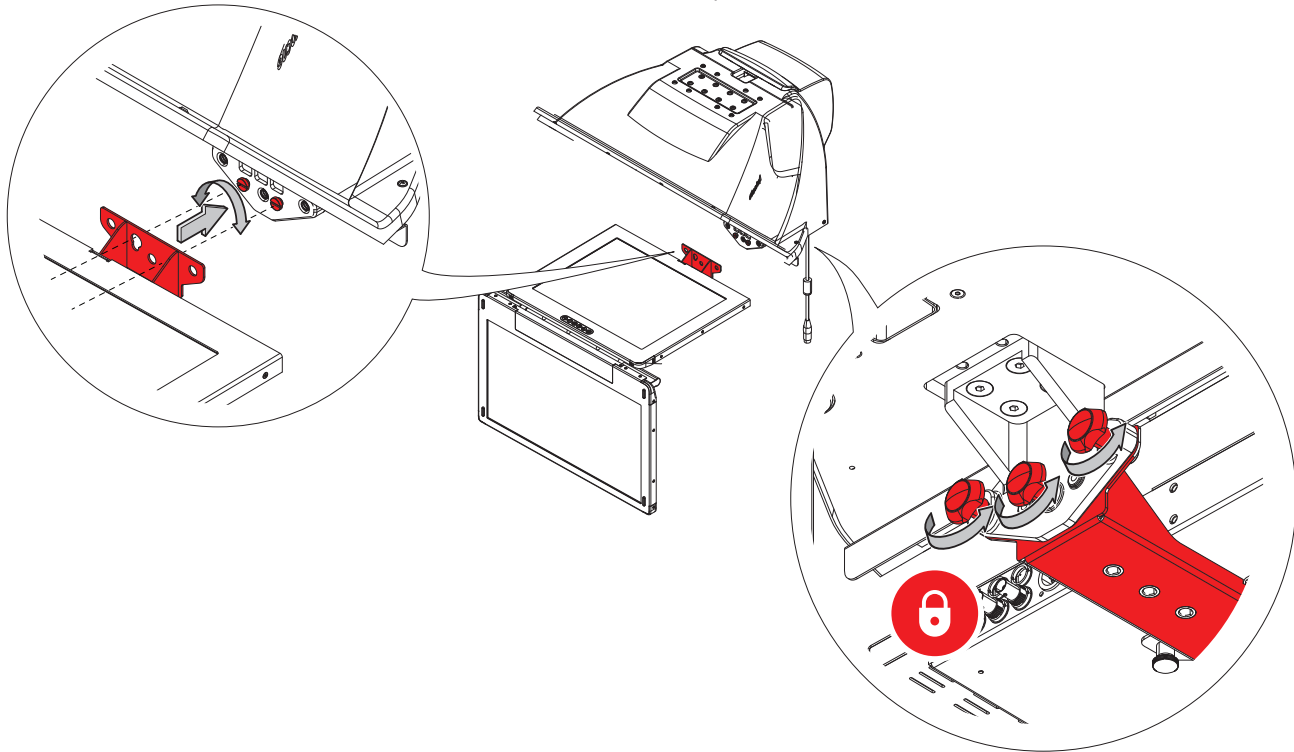

Maintenance

Routine Maintenance

The prompter assembly requires minimal routine maintenance, apart from checking the connections and overall operation periodically.

Routine checks

During use, check the following:

- Check cables for signs of wear or damage. Replace as necessary.
- Check that all cables are connected properly.
- Check fixings are all tight.

Cleaning



WARNING! Risk of electric shock. Disconnect and isolate the product from the power supply before cleaning.

During normal use the only cleaning required should be a regular wipe over with a dry, lint-free cloth. Dirt accumulated during storage or periods of disuse may be removed with a vacuum cleaner. Particular attention should be paid to all connection ports on the Prompter.

Reflective glass cleaning



WARNING! Risk of personal injury or injury to others. Care must be taken when handling or cleaning the reflective glass panels.

Care and cleaning of the reflective glass panel is essential for increased life and prompting display performance.

No solvents or glass cleaners should be used. Only use clean water and a damp lens cloth when cleaning. Do not apply excessive pressure to the reflective glass panel during the cleaning process.

General Product Safety Regulation (EU) 2023/988

Safe Disposal

This product and its components must be disposed of responsibly. Do not dispose of this product as unsorted household waste.

Improper disposal may cause harm to the environment and human health.

Packaging

All packaging materials are recyclable. Please recycle them through your local collection system. Whenever possible, reduce waste by reusing or recycling.

Sustainable Use

To reduce the environmental impact of your product:

- Use the product according to the instructions to extend its service life.
- Switch off when not in use to save energy.
- Where available, participate in take-back or refurbishment schemes.

Publication No. P7012-4980/1



www.autocue.com